

***Y PWYLLGOR
CYNLLUNIO***

19 EBRILL 2017

***RHANBARTH Y
DWYRAIN***

**PLANNING
COMMITTEE**

19 APRIL 2017

**AREA
EAST**



***CEISIADAU YR ARGYMHELLIR EU
BOD YN CAEL EU CYMERADWYO***

**APPLICATIONS RECOMMENDED
FOR APPROVAL**

E/32266

E/32266

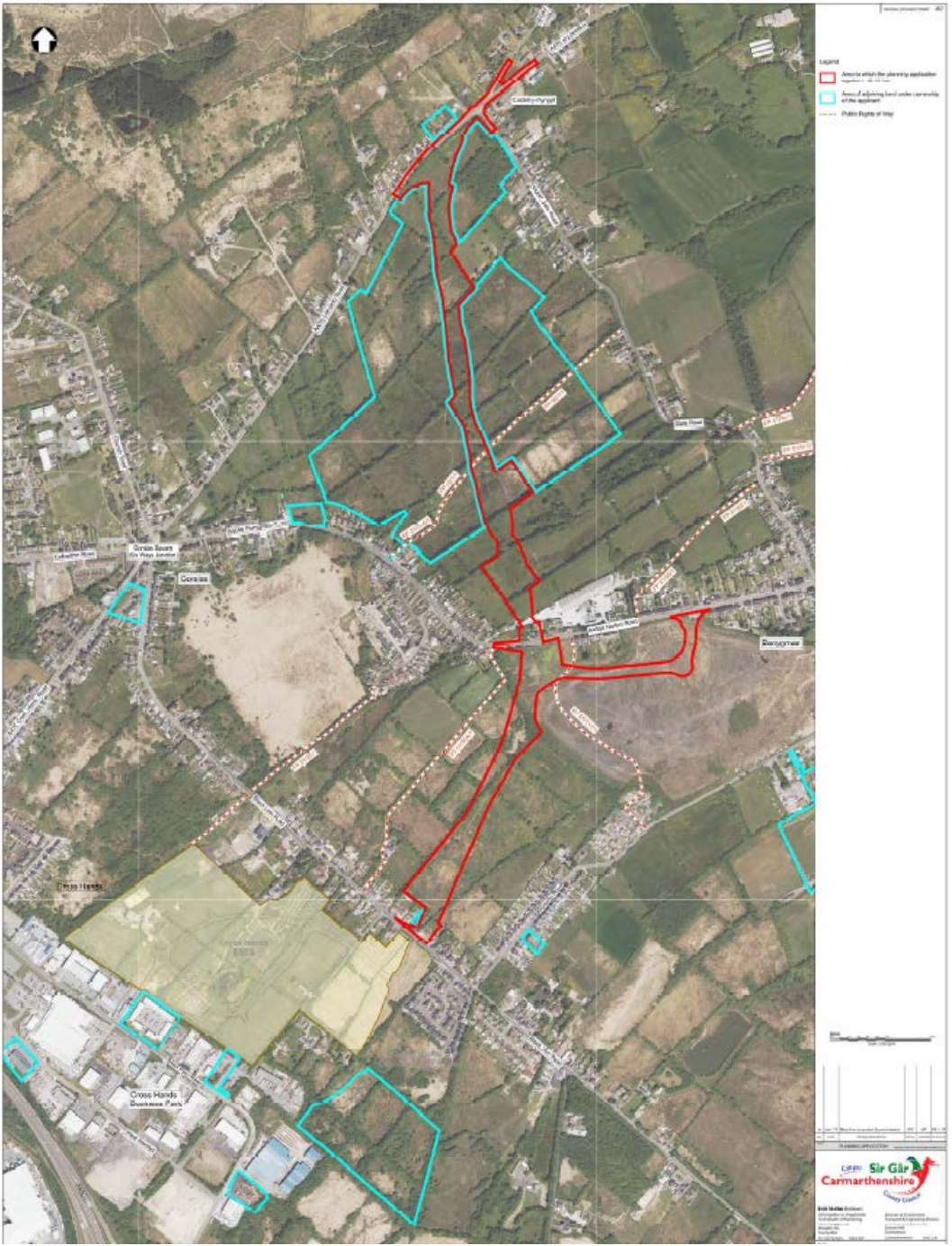

E/32266

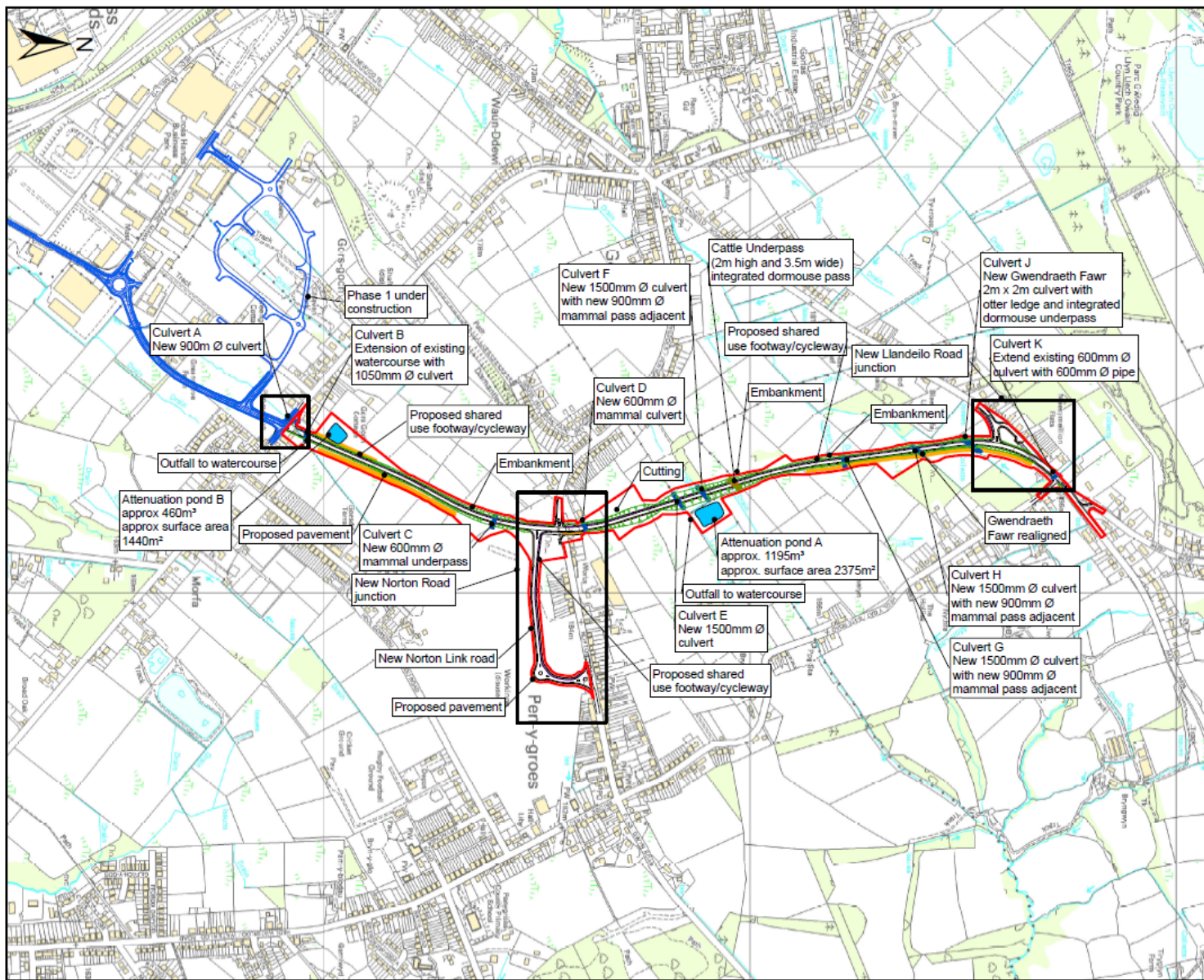

Figure 2.2

- Legend**
- Proposed scheme
 - Application boundary
 - Earthworks
 - Indicative bund locations
 - Cattle underpass
 - Culverts
 - Attenuation ponds
 - Cross Hands ELR phase 1 scheme
 - Proposed pavement
 - Proposed shared use footway/cycleway

Date	Rev	ISSUE	DR	CHK	APP
Jan15	0	INITIAL	AL	AL	AL
Feb15	1	Layer updates	AL	AL	AL
Feb17	2	Drainage update	AL	AL	AL

JACOBS
 Church House Church Way, CPO 24th, UK
 Tel: +44(0)1208 2322 Fax: +44(0)1208 2322
 www.jacobs.com



Project: Cross Hands Economic Link Road Phase 2 ES

Title: 2.2 Proposed Scheme

Status: Final
 Scale: 1:8,500 @ A3
 Access No: B2287400

Figure 2.2

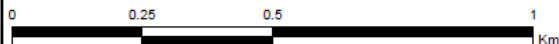

Reproduced from the Ordnance Survey Mapping with the permission of the Controller of Her Majesty's Stationary Office © Crown copyright. Unauthorised reproduction infringes Crown copyright and may lead to prosecution or civil proceedings. Ordnance Survey Licence No. AL10023377 (2017).

This drawing is not to be used in whole or part other than for the intended purpose and project as defined on this drawing. Refer to the contract for full terms and conditions.

E/32266

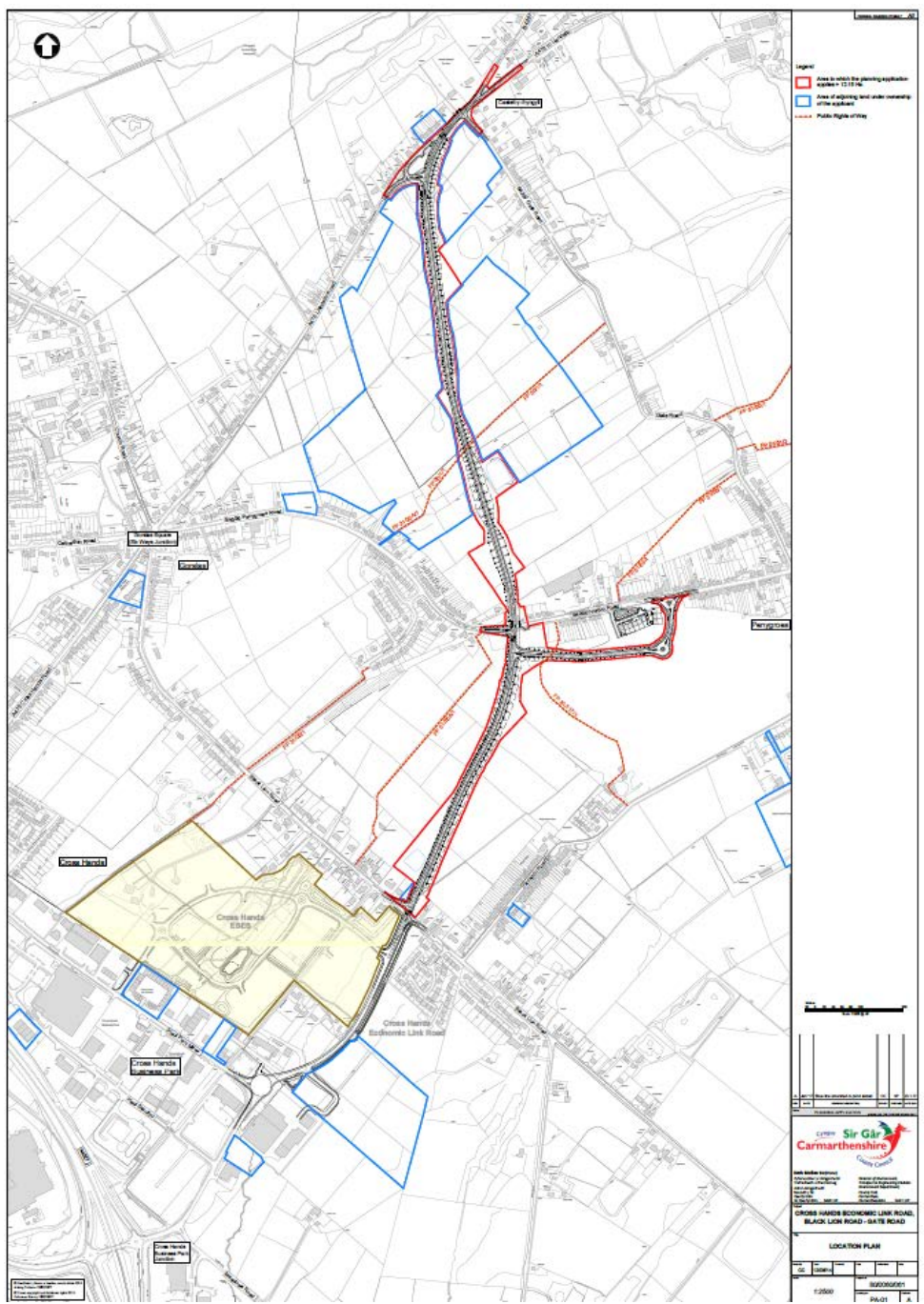

E/32266

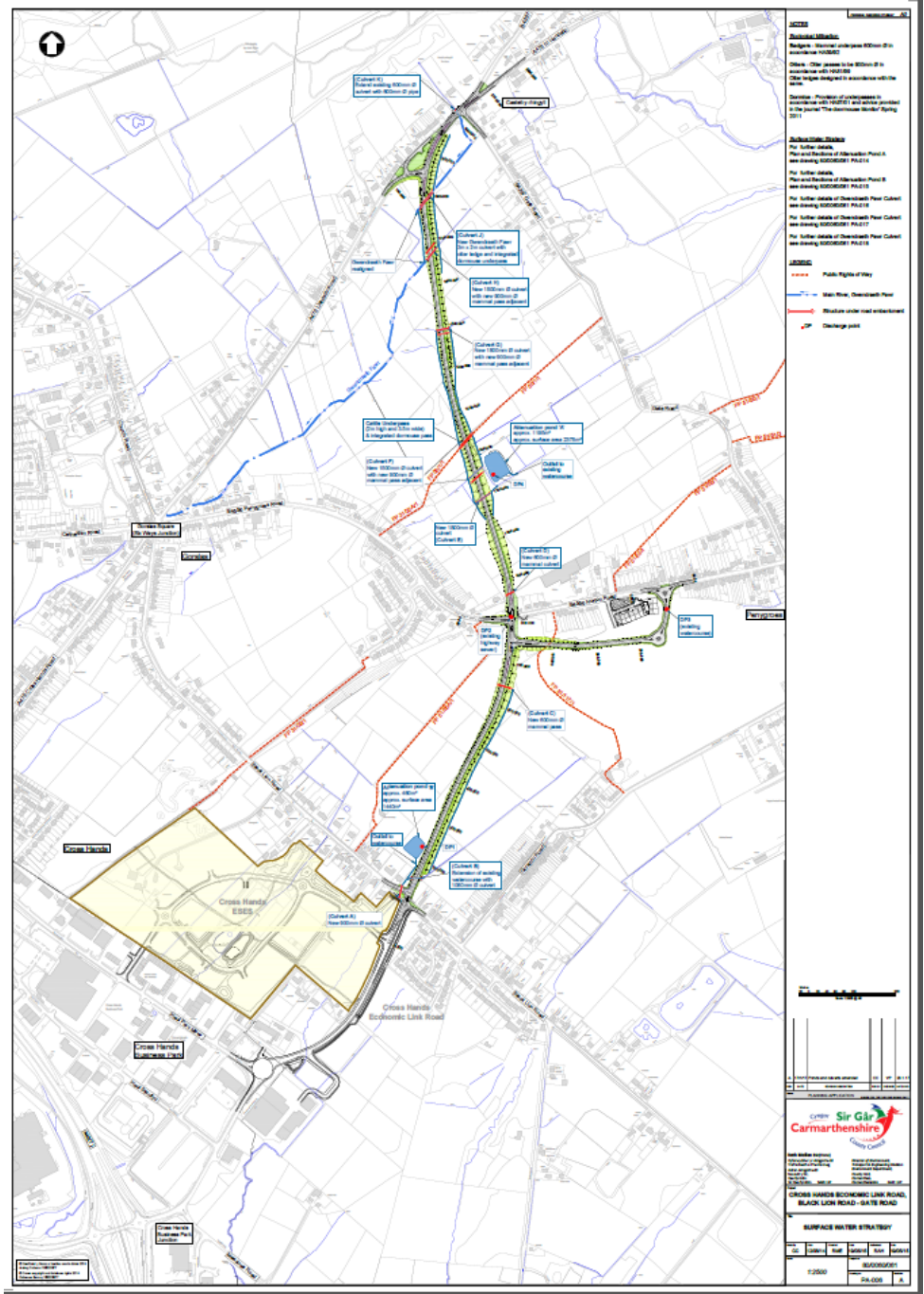

E/32266

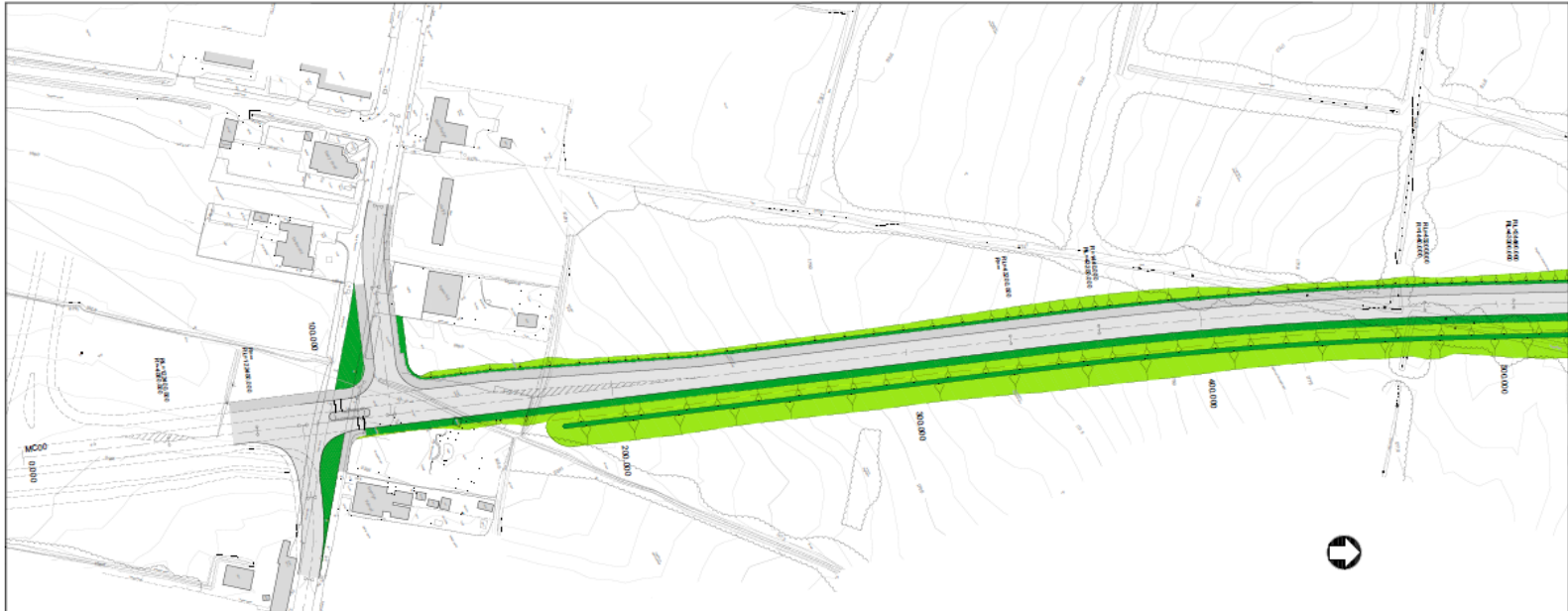

PLAN VIEW, CHAINAGE 0m to 500m
Scale 1:500

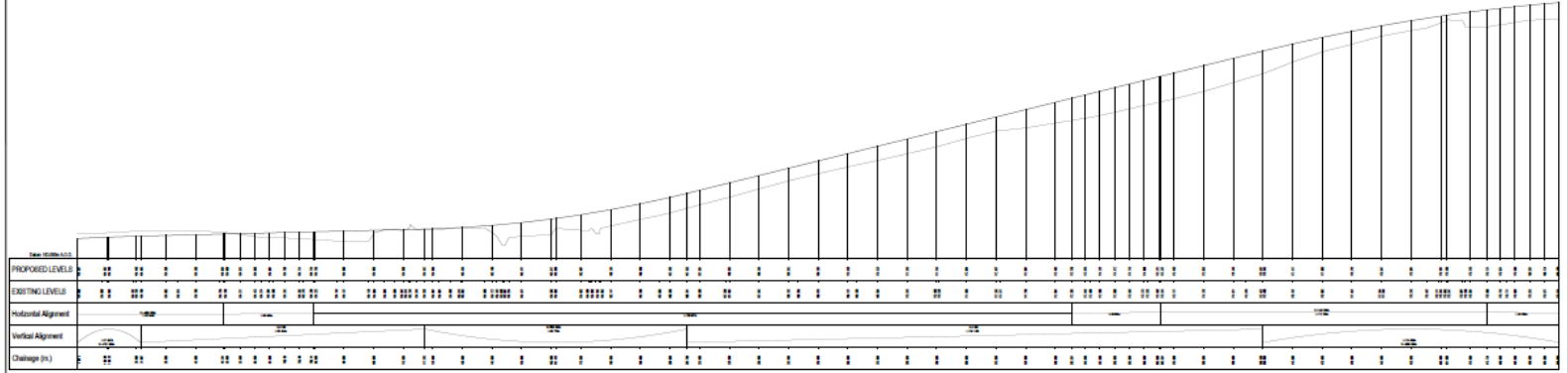

LONGITUDINAL SECTION ALONG PROPOSED CENTRELINE (MC00) Ch. 0 - 500m
Scale: Horiz. 1:500
Vert. 1:100



A 20211 Black Lion Road - Gate Road		CC	1/15	15.11.17
Scale	Horizontal	1:500	Vertical	1:100
Published 15/11/2017				
Ruth Mullen (Planning)		Director of Planning Planning & Development Planning Department 1000, LIP Carmarthen Carmarthenshire SA31 3LP		
Ruth Mullen (Planning)		Director of Planning Planning & Development Planning Department 1000, LIP Carmarthen Carmarthenshire SA31 3LP		
CROSS HANDS ECONOMIC LINK ROAD, BLACK LION ROAD - GATE ROAD				
CARRIAGEWAY ALIGNMENT Sheet 1 of 6				
CC	Fair15	v/Philipp	Fair15	v/Philipp
CC	Fair15	v/Philipp	Fair15	v/Philipp
80/0060/061				
As Shown				
				A

E/32266

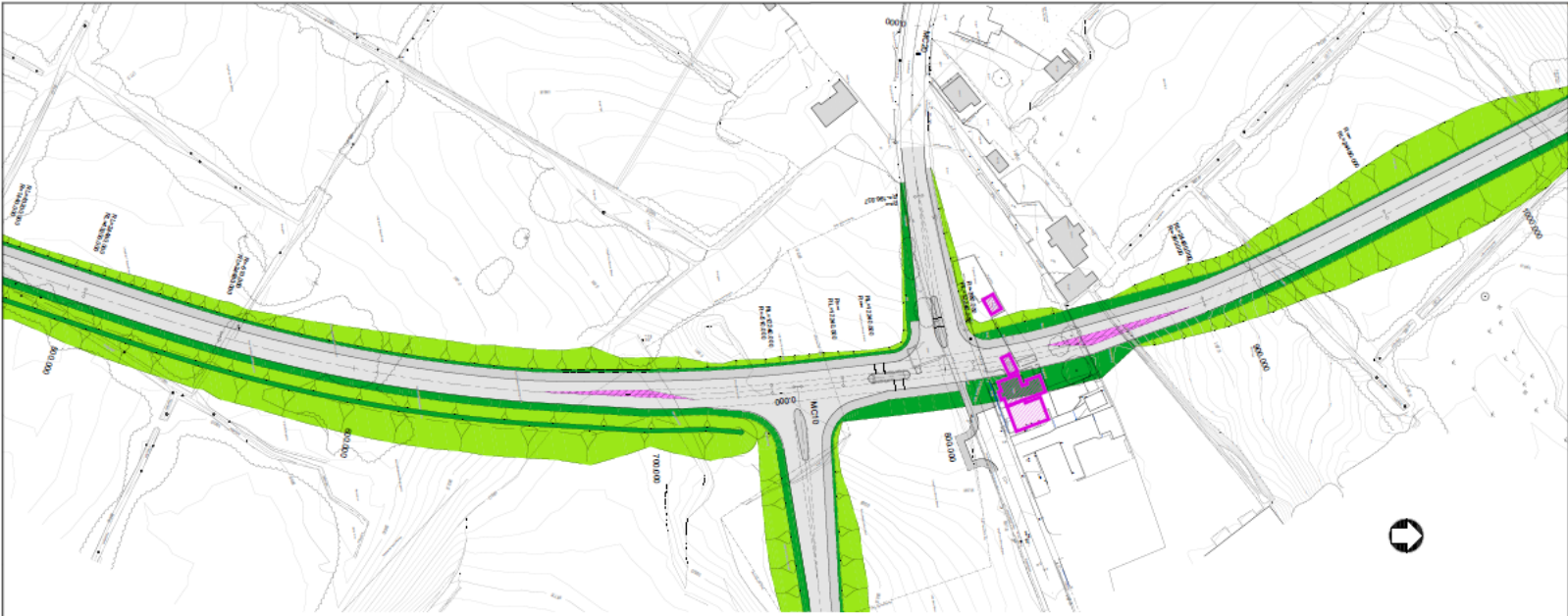

PLAN VIEW, CHAINAGE 500m to 1000m
Scale 1:500

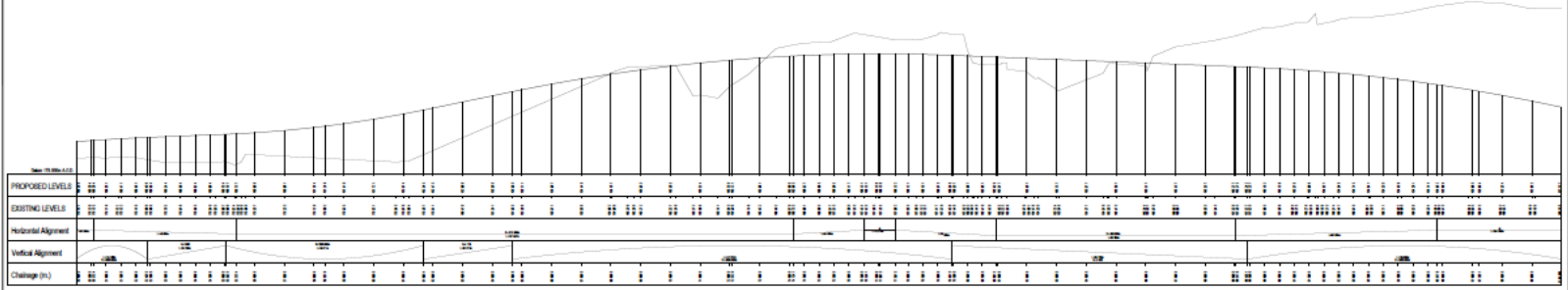

LONGITUDINAL SECTION ALONG PROPOSED CENTRELINE (MC00) Ch. 500 - 1000m
Scales: Horiz 1:500
Vert 1:100



CC	FA	PH	FA	PH	FA	PH

Cymru Sir Gâr Carmarthenshire
Carmarthenshire County Council

Head of Planning
Director of Planning
Director of Planning
Director of Planning
Director of Planning

CROSS HANDS ECONOMIC LINK ROAD,
BLACK LION ROAD - GATE ROAD

CARRIAGEWAY ALIGNMENT			
Sheet 2 of 8			
CC	FA	PH	FA
As Shown	80/0050/061	PA008	A

E/32266

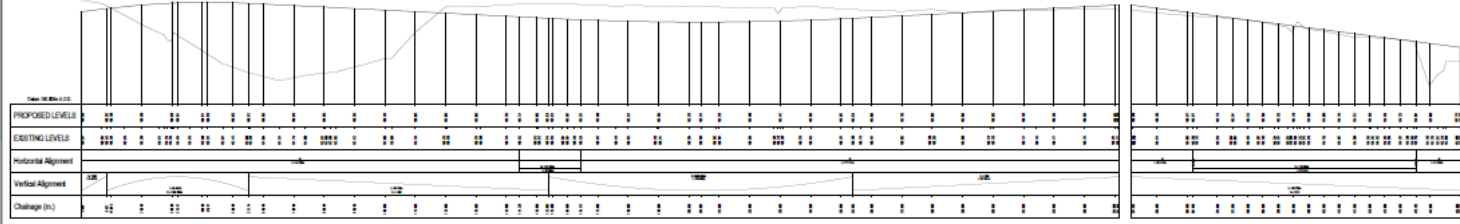
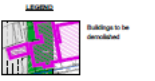
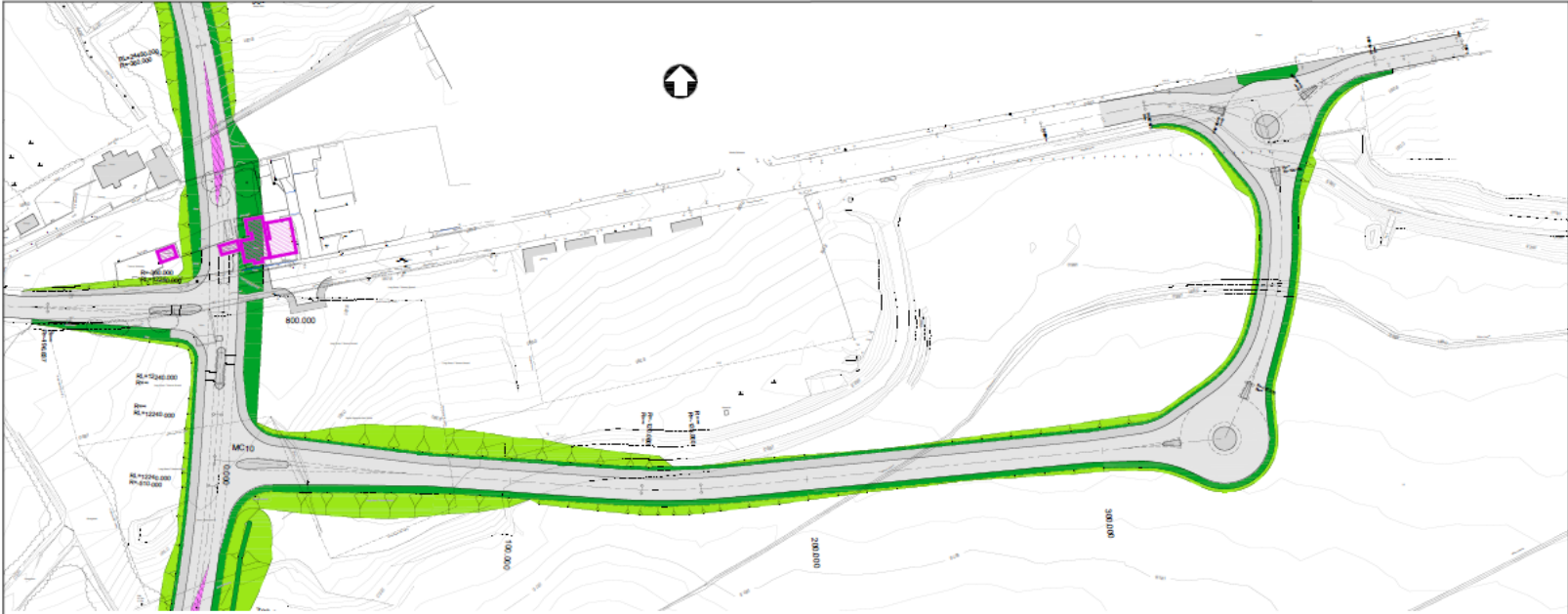

LONGITUDINAL SECTION ALONG PROPOSED CENTRELINE (MC10) Ch. 0m -

A	10/11/17	By: [Signature]	Checked: [Signature]	CC	DA	15.11.17
NO.	101	REVISION	DATE	BY	APPROVED	DATE
PUBLISHED APPLICATION: [Blank]						
Ruth Miller (Highway) Cymru Sir Gâr Department of Engineering Department of Planning County Hall Carmarthen Carmarthenshire SA31 3EQ						
CROSS HANDS ECONOMIC LINK ROAD, BLACK LION ROAD - GATE ROAD						
CARRIAGEWAY ALIGNMENT Sheet 6 of 6						
Scale	1:500	1:1000	1:2000	1:4000	1:8000	1:16000
Part	1	2	3	4	5	6
AS SHOWN			80/06/061			
PA-012						A

E/32266



E/32266

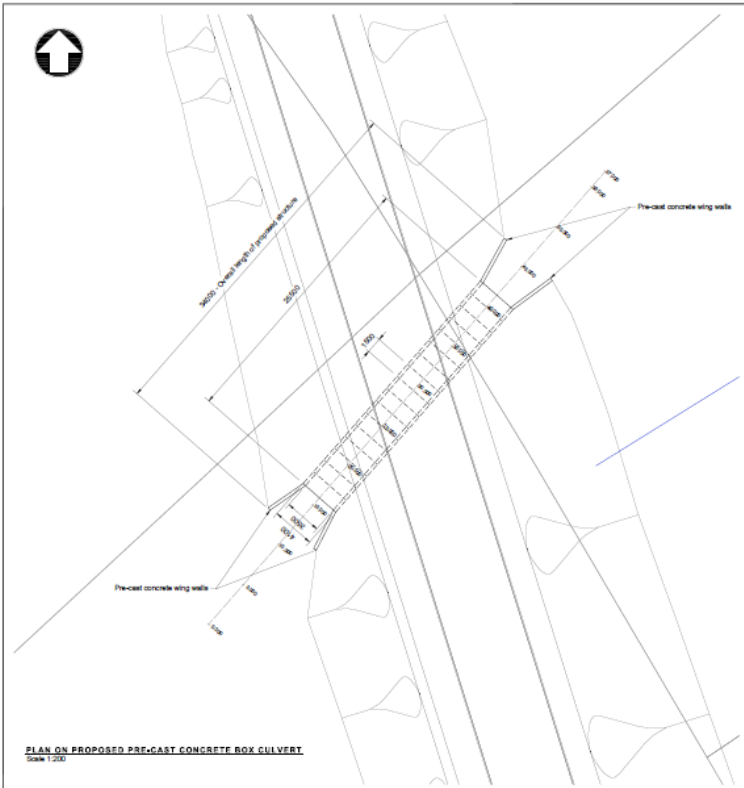

PLAN ON PROPOSED PRE-CAST CONCRETE BOX CULVERT
Scale 1:200

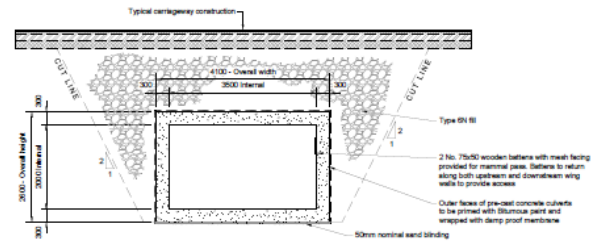
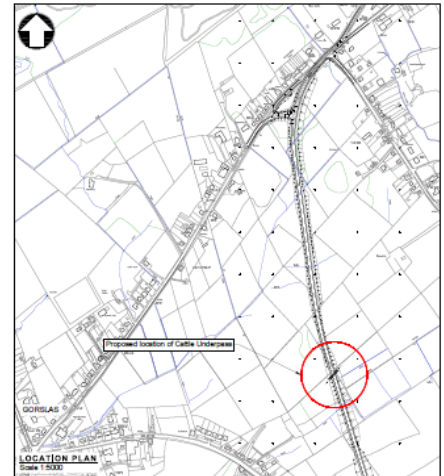

TYPICAL SECTION THROUGH PROPOSED PRE-CAST CONCRETE BOX CULVERT
Scale 1:50

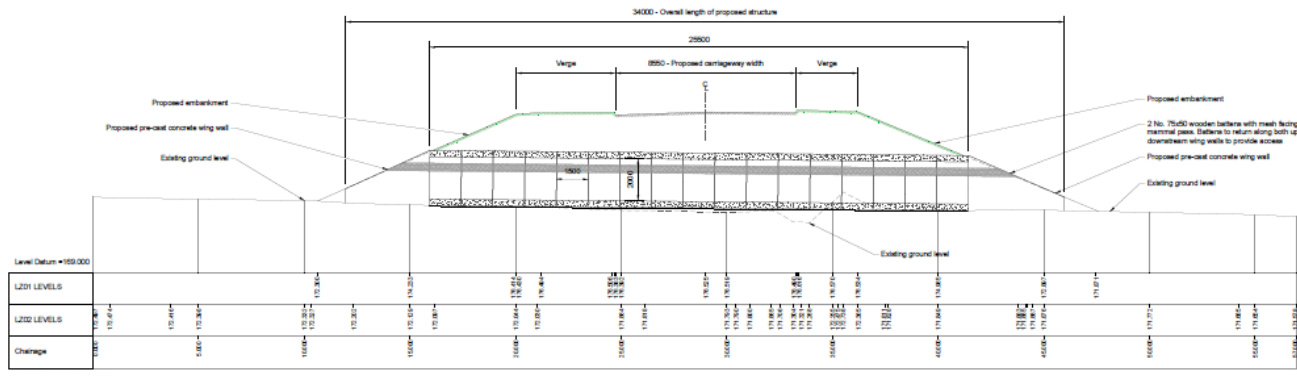

LONG SECTION THROUGH PROPOSED PRE-CAST CONCRETE BOX CULVERT
Scale 1:100

Cattle underpass since Ch. 260
Horizontal Scale = 1:100/Vertical Scale = 1:100

- NOTES** ORIGINAL DRAWING FORMAT **A1**
- All dimensions are in millimetres unless shown otherwise, and dimensions are not to be scaled from the drawing.
 - All levels are in metres above assumed datum.

NO.	DATE	DESCRIPTION	BY	CHECKED
1	10.01.17	ISSUED FOR PERMIT	JBW	VP

PLANNING APPLICATION

Ruth Mullen BSc. (Hons)
Carmarthenshire Planning Officer
1st Floor, The Council Offices, 10, High Street, Carmarthen, Carmarthenshire, SA31 1LP

Director of Environment
Highways and Transport Division,
Environment Department,
10, High Street, Carmarthen,
Carmarthenshire, SA31 1LP

**CROSS HANDS ECONOMIC LINK ROAD
BLACK LION ROAD - GATE ROAD**

PROPOSED CATTLE UNDERPASS

Drawn by	JBW	Date	12.01.17	Checked by	RME	Date	12.01.17	Submitted by	VP	Date	12.01.17
Project No.							80.0060.061				
AS SHOWN							PA-017				

© copyright © Crown & Souths 2017
© Crown copyright and database rights 2017
Database Survey 10002017

E/32266

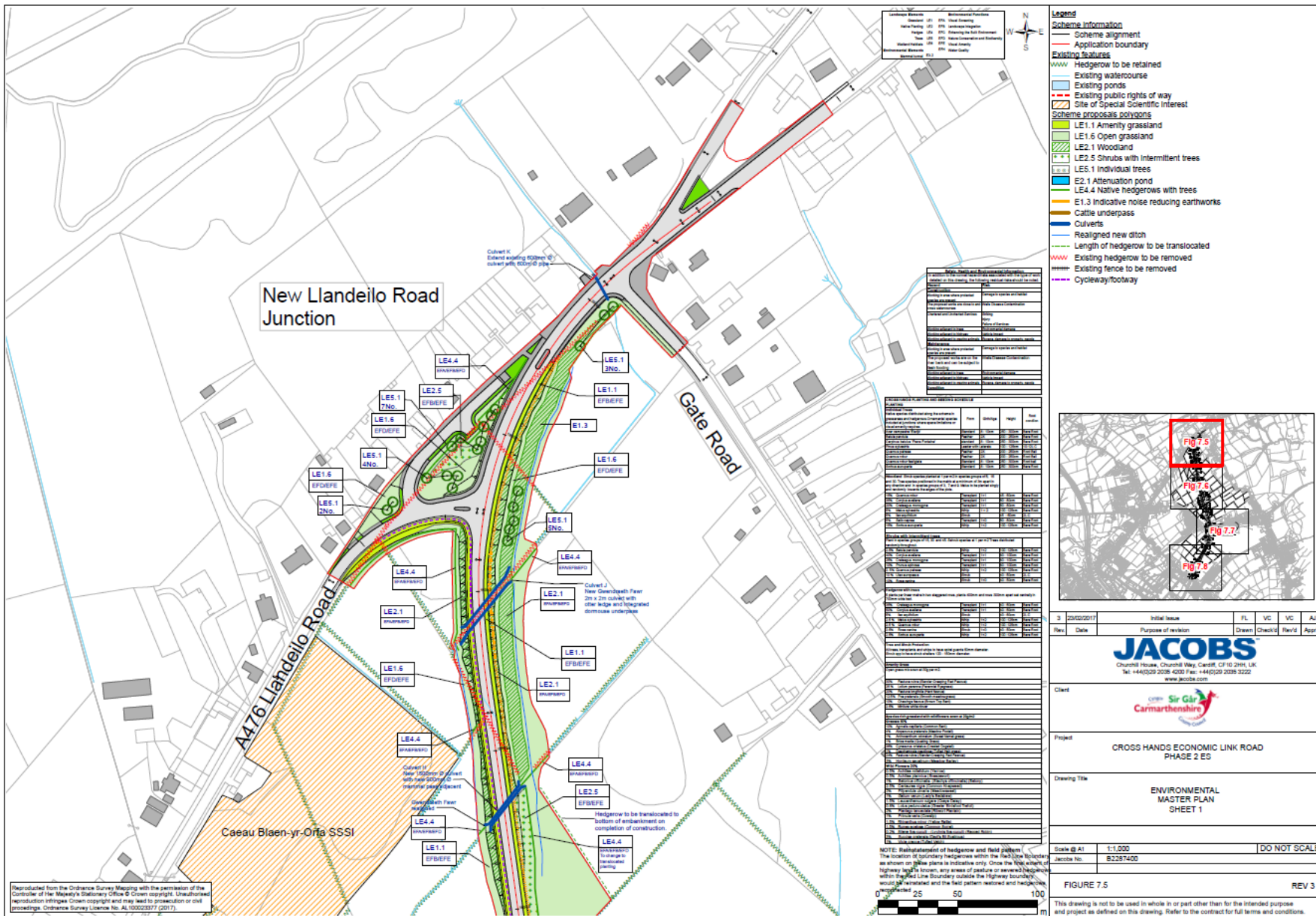

Reproduced from the Ordnance Survey Mapping with the permission of the Controller of Her Majesty's Stationery Office © Crown copyright. Unauthorized reproduction infringes Crown copyright and may lead to prosecution or civil proceedings. Ordnance Survey License No. AL102022217 (2017).

E/32266

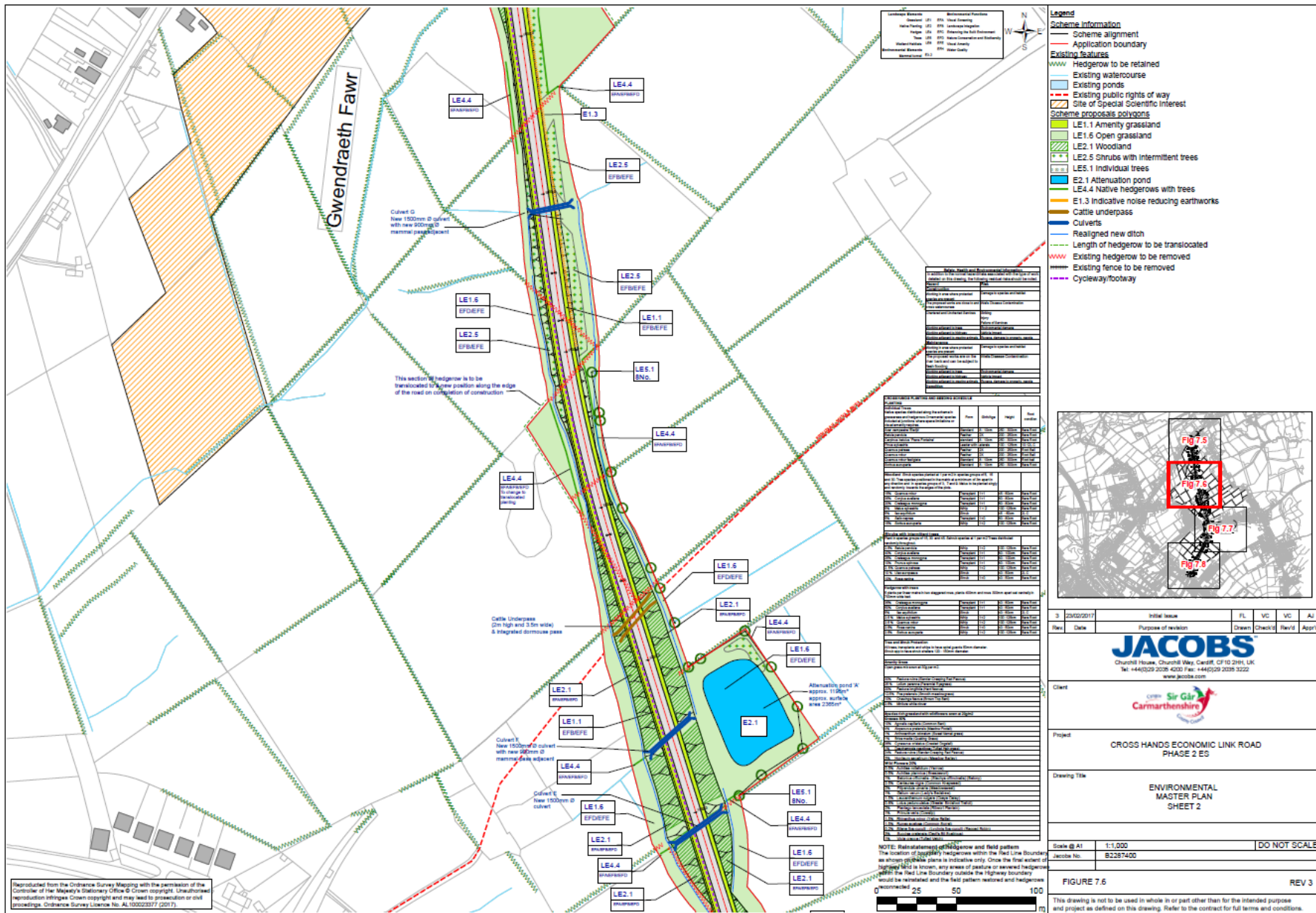

Reproduced from the Ordnance Survey Mapping with the permission of the Controller of Her Majesty's Stationary Office © Crown copyright. Unauthorised reproduction infringes Crown copyright and may lead to prosecution or civil proceedings. Ordnance Survey Licence No. AL100025177 (2017).

E/32266

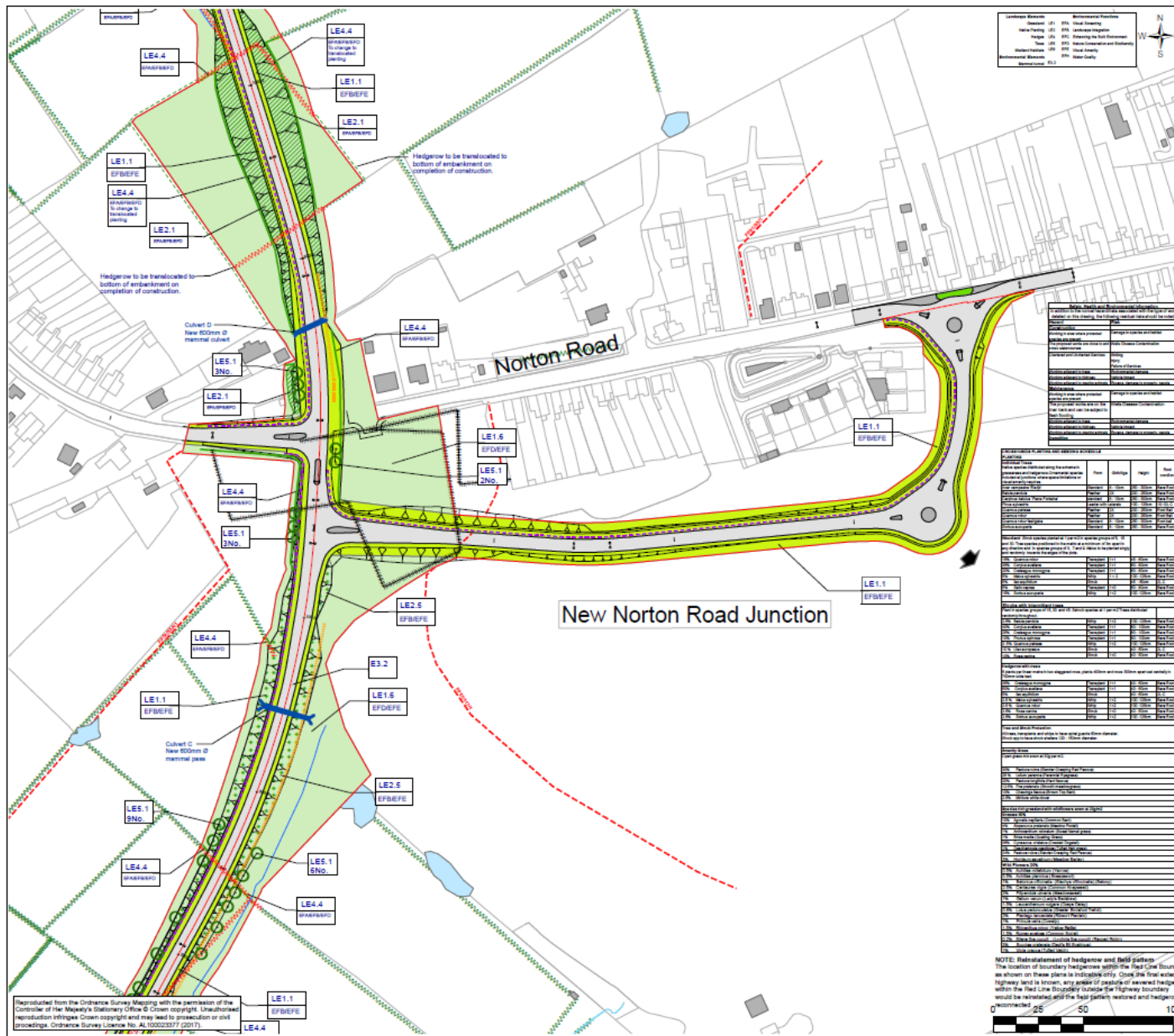

Legend

Scheme Information

- Scheme alignment
- Application boundary

Existing features

- Hedgerow to be retained
- Existing watercourse
- Existing ponds
- Existing public rights of way
- Site of Special Scientific Interest

Scheme proposals polygons

- LE1.1 Amenity grassland
- LE1.6 Open grassland
- LE2.1 Woodland
- LE2.5 Shrubs with intermittent trees
- LE5.1 Individual trees
- E2.1 Attenuation pond
- LE4.4 Native hedgerows with trees
- E1.3 Indicative noise reducing earthworks
- Cattle underpass
- Culverts
- Realigned new ditch
- Length of hedgerow to be translocated
- Existing hedgerow to be removed
- Existing fence to be removed
- Cycleway/footway

Legend

Scheme Information

- Scheme alignment
- Application boundary

Existing features

- Hedgerow to be retained
- Existing watercourse
- Existing ponds
- Existing public rights of way
- Site of Special Scientific Interest

Scheme proposals polygons

- LE1.1 Amenity grassland
- LE1.6 Open grassland
- LE2.1 Woodland
- LE2.5 Shrubs with intermittent trees
- LE5.1 Individual trees
- E2.1 Attenuation pond
- LE4.4 Native hedgerows with trees
- E1.3 Indicative noise reducing earthworks
- Cattle underpass
- Culverts
- Realigned new ditch
- Length of hedgerow to be translocated
- Existing hedgerow to be removed
- Existing fence to be removed
- Cycleway/footway

Legend

Scheme Information

- Scheme alignment
- Application boundary

Existing features

- Hedgerow to be retained
- Existing watercourse
- Existing ponds
- Existing public rights of way
- Site of Special Scientific Interest

Scheme proposals polygons

- LE1.1 Amenity grassland
- LE1.6 Open grassland
- LE2.1 Woodland
- LE2.5 Shrubs with intermittent trees
- LE5.1 Individual trees
- E2.1 Attenuation pond
- LE4.4 Native hedgerows with trees
- E1.3 Indicative noise reducing earthworks
- Cattle underpass
- Culverts
- Realigned new ditch
- Length of hedgerow to be translocated
- Existing hedgerow to be removed
- Existing fence to be removed
- Cycleway/footway

Legend

Scheme Information

- Scheme alignment
- Application boundary

Existing features

- Hedgerow to be retained
- Existing watercourse
- Existing ponds
- Existing public rights of way
- Site of Special Scientific Interest

Scheme proposals polygons

- LE1.1 Amenity grassland
- LE1.6 Open grassland
- LE2.1 Woodland
- LE2.5 Shrubs with intermittent trees
- LE5.1 Individual trees
- E2.1 Attenuation pond
- LE4.4 Native hedgerows with trees
- E1.3 Indicative noise reducing earthworks
- Cattle underpass
- Culverts
- Realigned new ditch
- Length of hedgerow to be translocated
- Existing hedgerow to be removed
- Existing fence to be removed
- Cycleway/footway

Legend

Scheme Information

- Scheme alignment
- Application boundary

Existing features

- Hedgerow to be retained
- Existing watercourse
- Existing ponds
- Existing public rights of way
- Site of Special Scientific Interest

Scheme proposals polygons

- LE1.1 Amenity grassland
- LE1.6 Open grassland
- LE2.1 Woodland
- LE2.5 Shrubs with intermittent trees
- LE5.1 Individual trees
- E2.1 Attenuation pond
- LE4.4 Native hedgerows with trees
- E1.3 Indicative noise reducing earthworks
- Cattle underpass
- Culverts
- Realigned new ditch
- Length of hedgerow to be translocated
- Existing hedgerow to be removed
- Existing fence to be removed
- Cycleway/footway

Legend

Scheme Information

- Scheme alignment
- Application boundary

Existing features

- Hedgerow to be retained
- Existing watercourse
- Existing ponds
- Existing public rights of way
- Site of Special Scientific Interest

Scheme proposals polygons

- LE1.1 Amenity grassland
- LE1.6 Open grassland
- LE2.1 Woodland
- LE2.5 Shrubs with intermittent trees
- LE5.1 Individual trees
- E2.1 Attenuation pond
- LE4.4 Native hedgerows with trees
- E1.3 Indicative noise reducing earthworks
- Cattle underpass
- Culverts
- Realigned new ditch
- Length of hedgerow to be translocated
- Existing hedgerow to be removed
- Existing fence to be removed
- Cycleway/footway

Legend

Scheme Information

- Scheme alignment
- Application boundary

Existing features

- Hedgerow to be retained
- Existing watercourse
- Existing ponds
- Existing public rights of way
- Site of Special Scientific Interest

Scheme proposals polygons

- LE1.1 Amenity grassland
- LE1.6 Open grassland
- LE2.1 Woodland
- LE2.5 Shrubs with intermittent trees
- LE5.1 Individual trees
- E2.1 Attenuation pond
- LE4.4 Native hedgerows with trees
- E1.3 Indicative noise reducing earthworks
- Cattle underpass
- Culverts
- Realigned new ditch
- Length of hedgerow to be translocated
- Existing hedgerow to be removed
- Existing fence to be removed
- Cycleway/footway

Legend

Scheme Information

- Scheme alignment
- Application boundary

Existing features

- Hedgerow to be retained
- Existing watercourse
- Existing ponds
- Existing public rights of way
- Site of Special Scientific Interest

Scheme proposals polygons

- LE1.1 Amenity grassland
- LE1.6 Open grassland
- LE2.1 Woodland
- LE2.5 Shrubs with intermittent trees
- LE5.1 Individual trees
- E2.1 Attenuation pond
- LE4.4 Native hedgerows with trees
- E1.3 Indicative noise reducing earthworks
- Cattle underpass
- Culverts
- Realigned new ditch
- Length of hedgerow to be translocated
- Existing hedgerow to be removed
- Existing fence to be removed
- Cycleway/footway

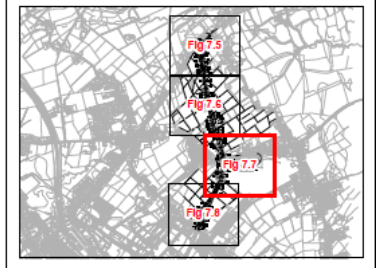

3	23/02/2011	Initial Issue	FL	VC	VC	AJ
Rev	Date	Purpose of revision	Drawn	Checked	Rev'd	App'd
<p>Churchill House, Churchill Way, Cardiff, CF10 2HF, UK Tel: +44(0)29 2026 4000 Fax: +44(0)29 2026 3222 www.jacobs.com</p>						
Client						
<p>CROSS HANDS ECONOMIC LINK ROAD PHASE 2 ES</p>						
Drawing Title						
<p>ENVIRONMENTAL MASTER PLAN SHEET 3</p>						
Scale @ A1	1:1,000	DO NOT SCALE				
Jacobs No.	E2287420					
FIGURE 7.7	REV 3					

Reproduced from the Ordnance Survey Mapping with the permission of the Controller of the Majesty's Stationery Office © Crown copyright. Unauthorised reproduction infringes Crown copyright and may lead to prosecution or civil proceedings. Ordnance Survey License No. AL100023377 (2017)

NOTE: Reinstatement of hedgerow and field patterns - The location of boundary hedgerows within the Red Line boundary as shown on these plans is indicative only. Once the final extent of highway land is known, any public or private of reserved hedgerows within the Red Line boundary outside the Highway boundary would be retained and the field pattern restored and hedgerows reinstated.

Scale 1:1,000

0 25 50 100 m

N:\32266\CARMARTHENSHIRE FRAMEWORK\Cross Hands ELR Phase 2 E1240154\GIS\MA\DWG\MF02287400_007_Rev3_EnvironmentalMasterplan.mxd

E/32266

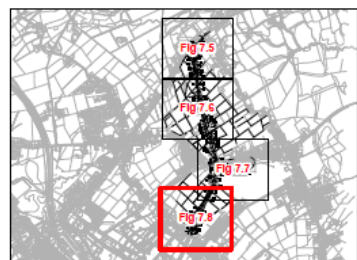
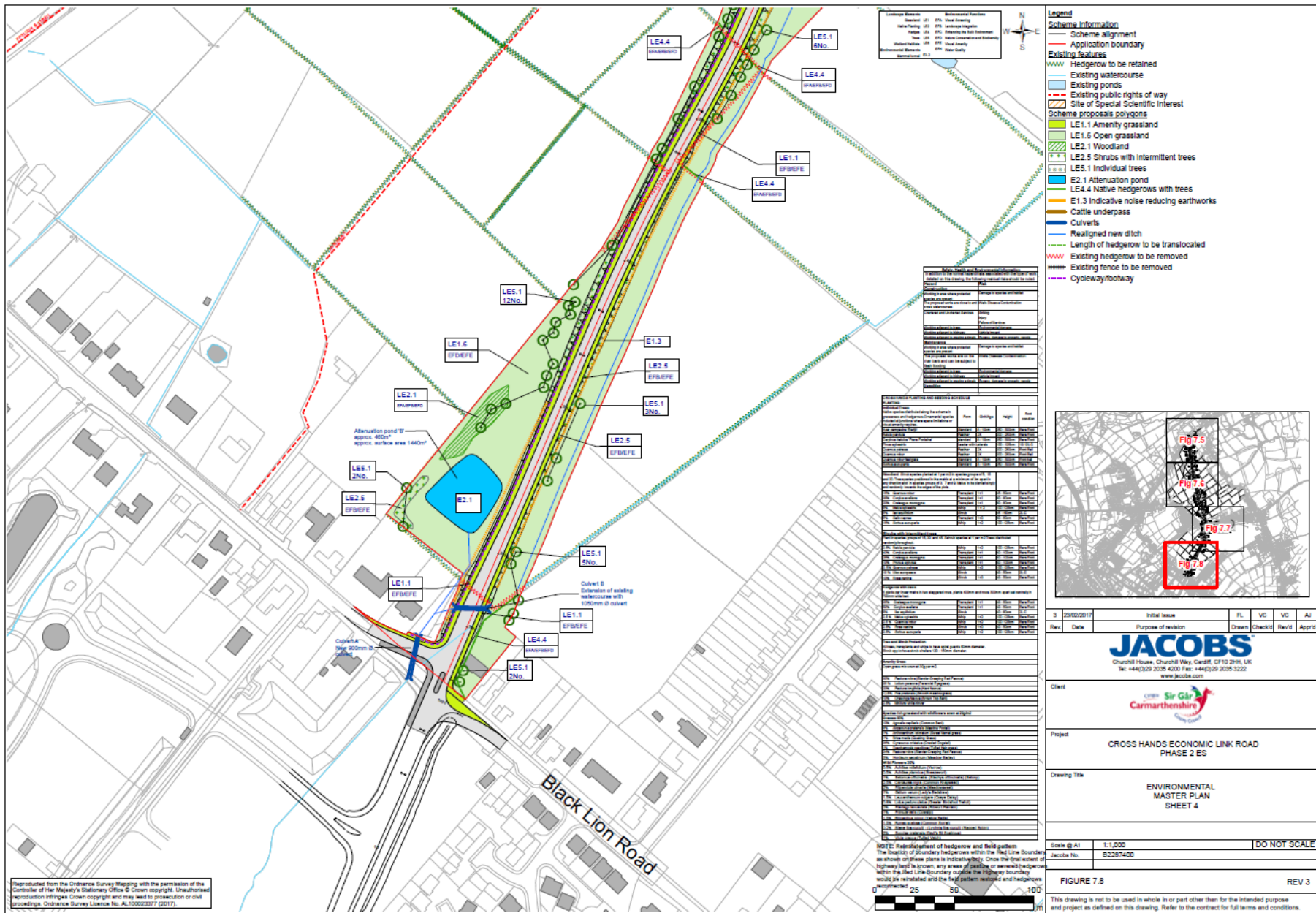

3	20/03/2017	Initial Issue	FL	VC	VC	AJ
Rev	Date	Purpose of revision	Drawn	Checked	Revised	Approved
<p>Churchill House, Churchill Way, Cardiff, CF10 2HN, UK Tel: +44(0)29 2035 4200 Fax: +44(0)29 2035 5222 www.jacobs.com</p>						
Client						
Project						
CROSS HANDS ECONOMIC LINK ROAD PHASE 2 ES						
Drawing Title						
ENVIRONMENTAL MASTER PLAN SHEET 4						
Scale @ A1						
1:1,000					DO NOT SCALE	
Sheet No: 82387400						
FIGURE 7.8						
						REV 3

Reproduced from the Ordnance Survey Mapping with the permission of the Controller of the Majesty's Stationery Office © Crown copyright. Unauthorised reproduction infringes Crown copyright and may lead to prosecution or civil proceedings. Ordnance Survey Licence No. AL10002377 (2017).

E/32266



E/32266



E/32266



E/32266



E/32266



E/32266



E/32266



E/32266



E/32266



E/32266



E/32266



E/32266





E/34580

E/34580 Location Plan (OS Map)

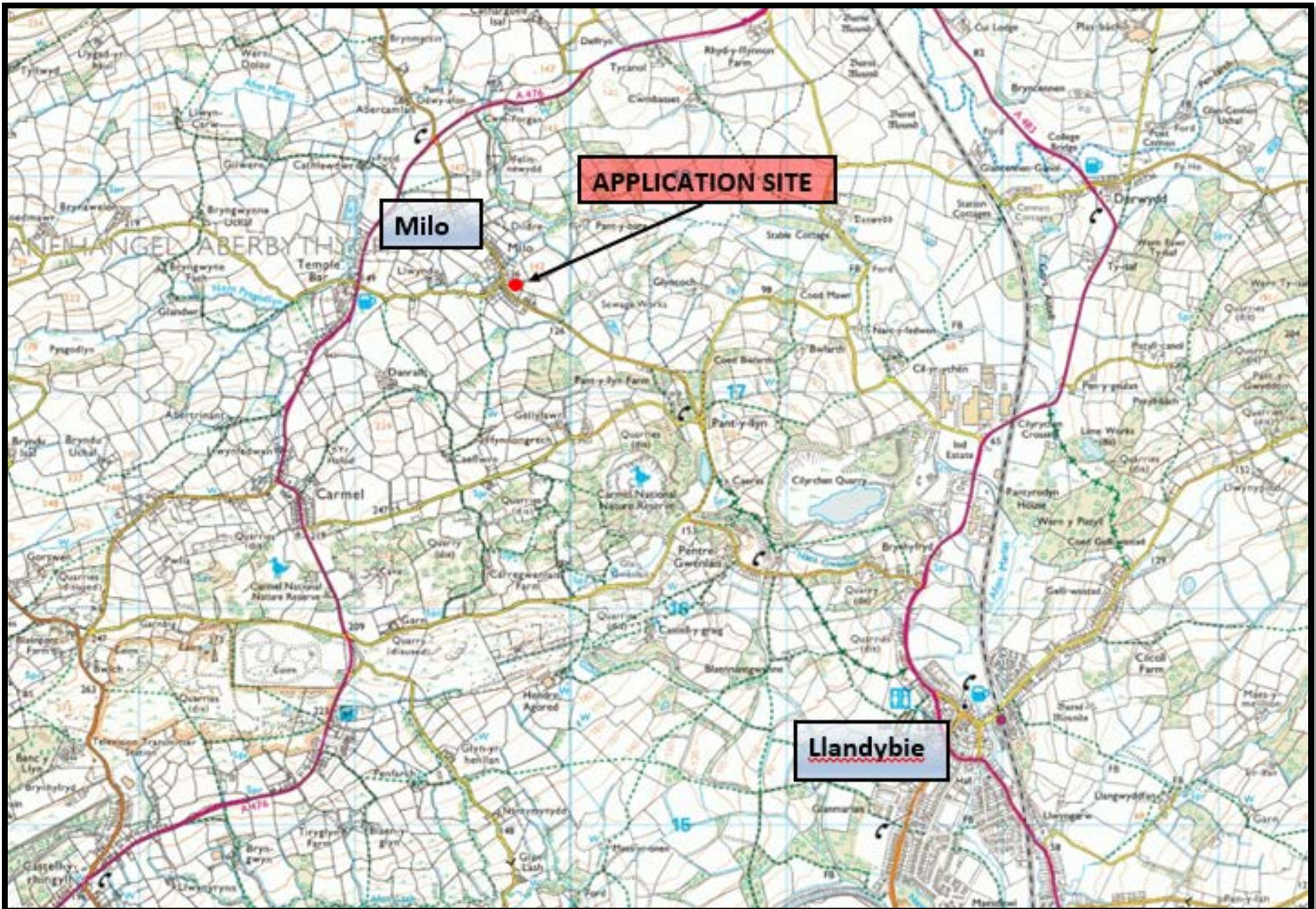

E/34580

Location Plan

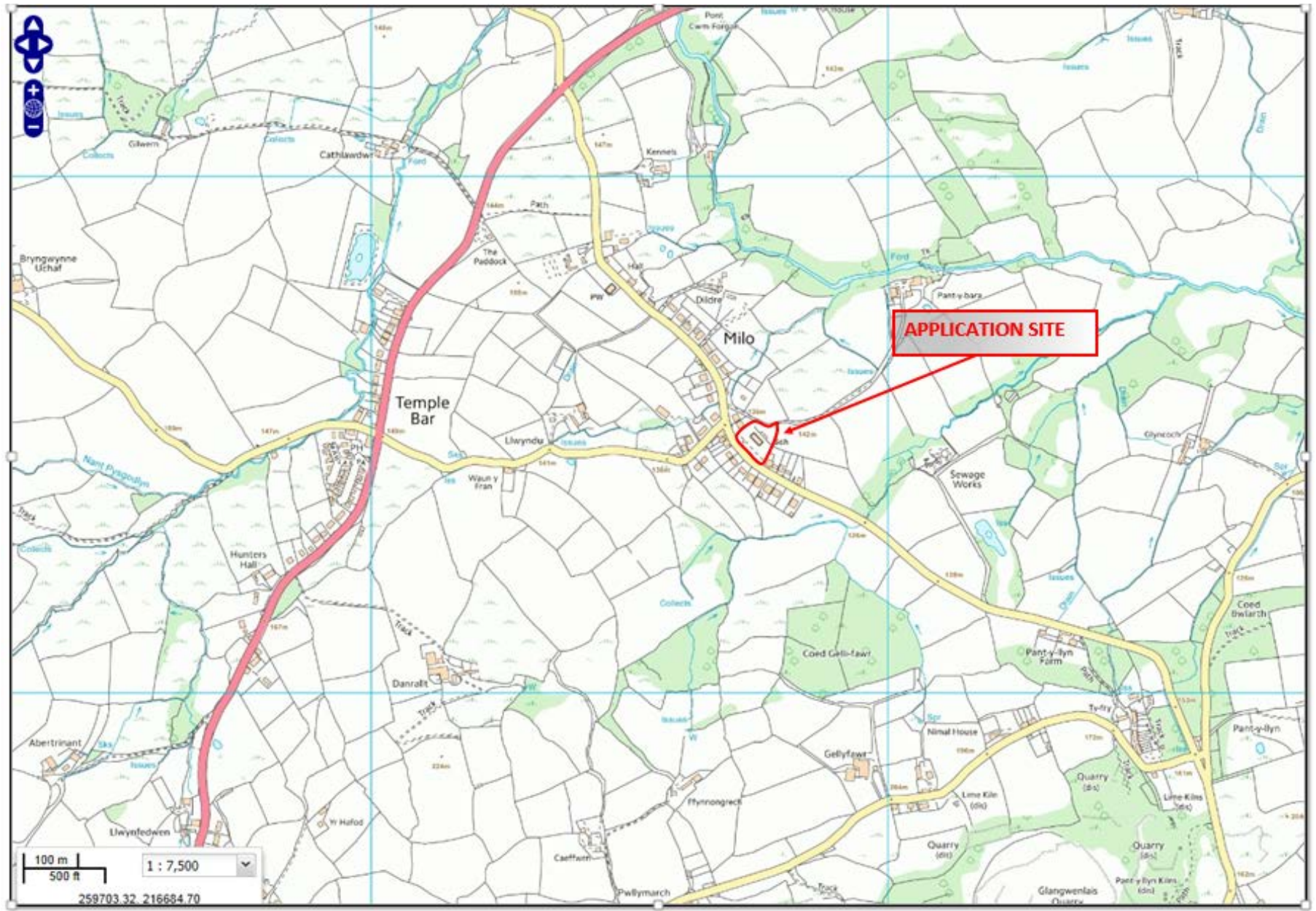

E/34580

Aerial Photograph



E/34580

Existing Site Plan

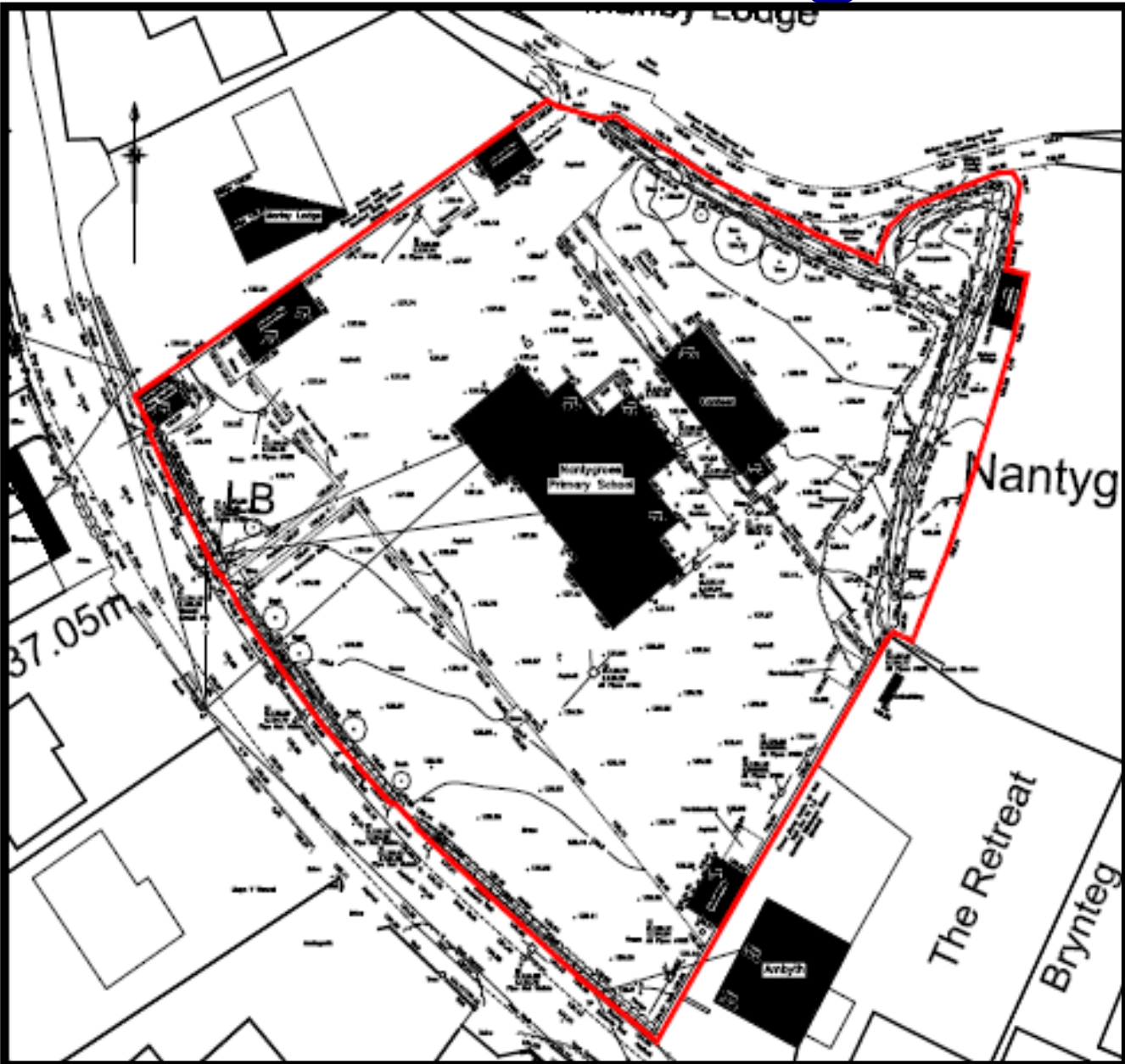

E/34580 Indicative Site Layout

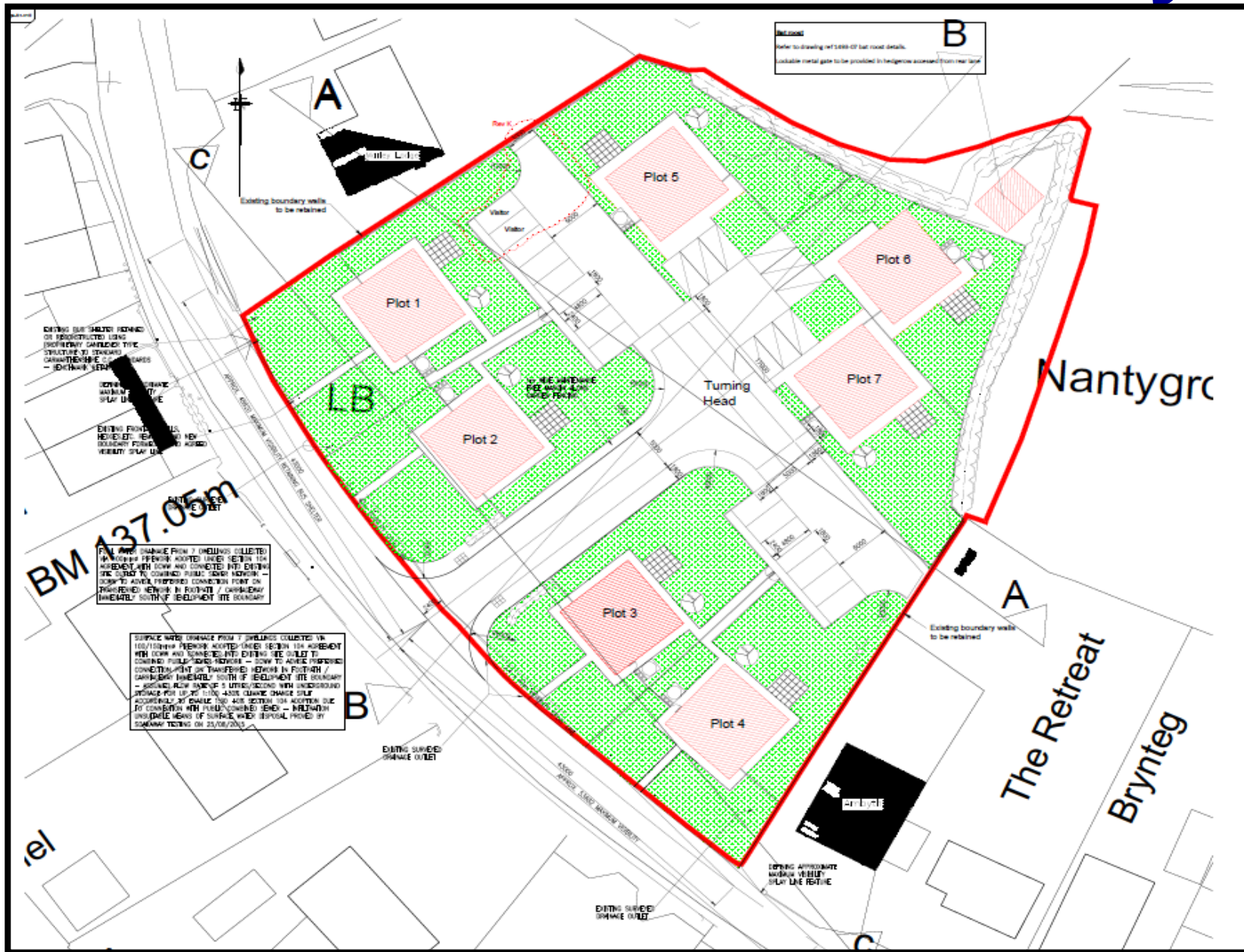

E/34580



E/34580



E/34580



E/34580



E/34580



E/34580



E/34580 : C2145 Heading south-east out of Milo towards Pentregwenlais



E/34580 : C2145 Heading north-west into the village of Milo





E/35287

E/35287



E/35287



E/35287

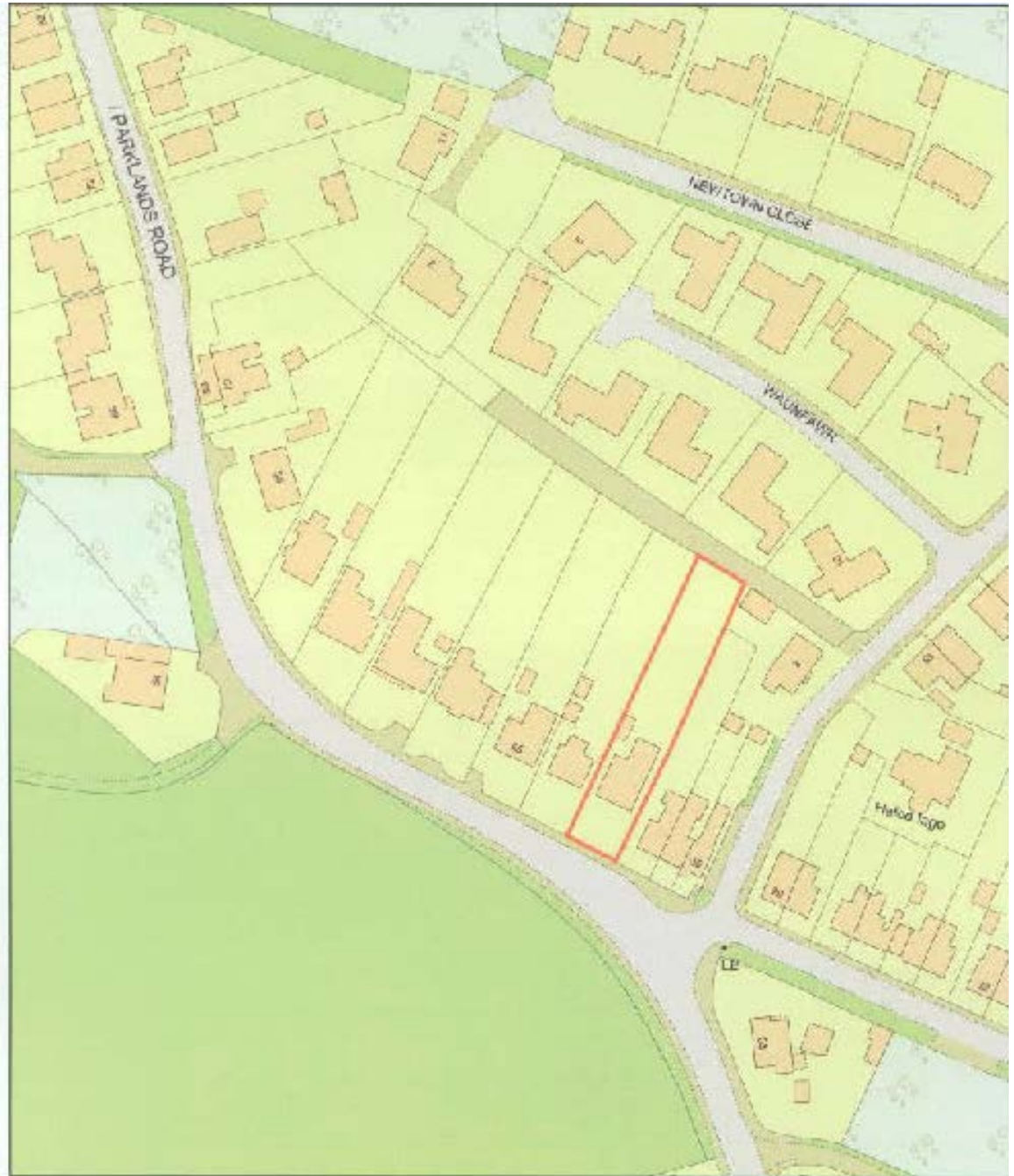

E/35287



E/35287

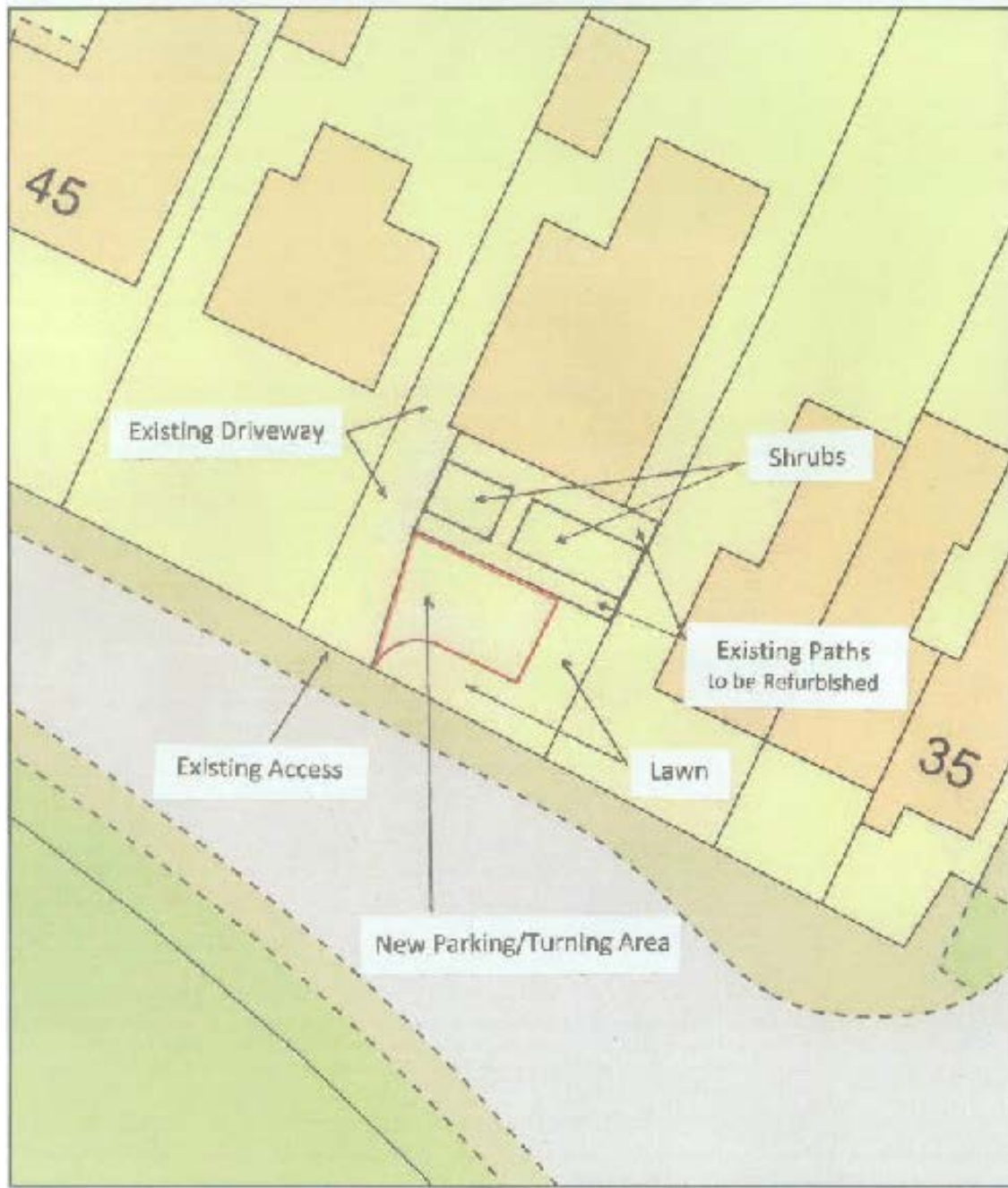

E/35287



E/35287

